

A

B

C

D

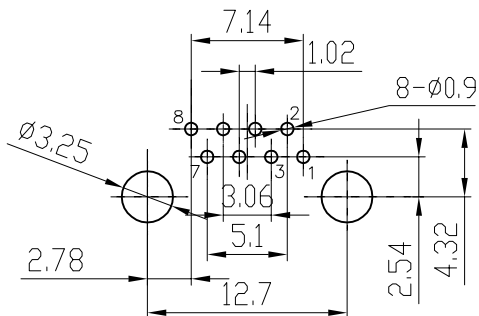

RECOMMENDED PC BOARD LAYOUT
PCB THICKNESS=1.6mm
AS VIEWED FROM COMPONENT SIDE
TOLERANCE $\pm 0.05\text{mm}$

NOTES:

1. ELECTRICAL:

- 1.1 VOLTAGE RATING: 150 VAC RMS;
- 1.2 CURRENT RATING: 1.5 AMP @25°C;
- 1.3 CONTACT RESISTANCE: 20 MILLIOHMS Max;
- 1.4 INSULATION RESISTANCE: 1000 MEGOHMS Min @500 VDC;
- 1.5 DIELECTRIC STRENGTH: CONTACT TO CONTACT 1000V DC OR AC PEAK
: CONTACT TO SCREEN AND TEST PANEL: 1500V DC OR AC PEAK
@0.5mA 50Hz or 60 Hz a Minute;

2. MECHANICAL:

- 2.1 HOUSING: SEE TABLE;
- 2.2 TERMINALS: 0.36X0.46mm THICK PHOSPHOR BRONZE
- 2.3 PLATING: 1: CONTACT AREA- SELECTIVE GOLD PLATING
2: TAILS PLATING MATTE TIN 150u" MIN OVER NICKEL 50u" MIN.
- 2.4 DURABILITY: 750 times.
- 2.5 MATING/UNMATING FORCE: 30N Max.
- 2.6 RETENTION STRENGTH: 50N FOR 60S $\pm 5\text{S}$.

环境特性:

1. 储存温度: -40°C~+85°C 相对湿度<80%.
2. 工作温度: -40°C~+85°C
3. 储存时间: 12个月
4. 波峰焊温度: 265 ± 5 °C 10S

ENVIRONMENTAL:

1. STORAGE TEMPERATURE : -40°C~+85°C RELATIVE HUMIDITY<80%
 2. OPERATION TEMPERATURE : -40°C~+85°C
 3. GUARANTEE PERIOD : 12 MONTHS
 4. wave-soldering : 265 ± 5 °C 10S
- MATES WITH MODULAR PLUG CONFORMING TO FCC PART 68, SUBPART F.

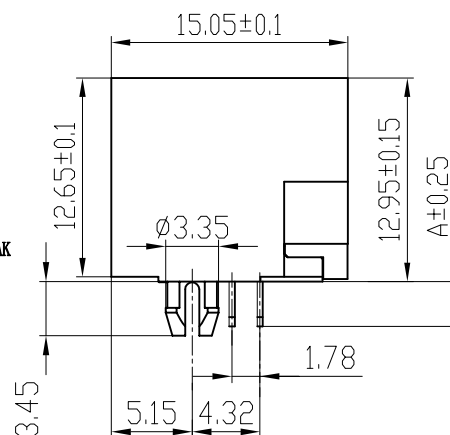
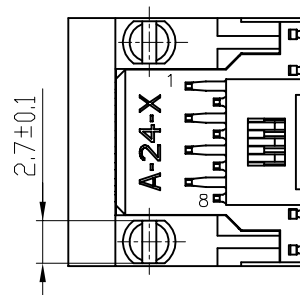

电气特性:

1. 额定电压: 150 VAC RMS
2. 额定电流: 1.5 AMPS@25°C
3. 接触电阻: 20mΩ MAX.
4. 绝缘电阻: 1000 MΩ MIN. @500 VDC
5. 耐压强度: : CONTACT TO CONTACT : 1000V DC OR AC PEAK;
: CONTACT TO SCREEN AND TEST PANEL : 1500V DC OR AC PEAK
@0.5mA 50Hz 或 60Hz 一分钟.

商标有无互换

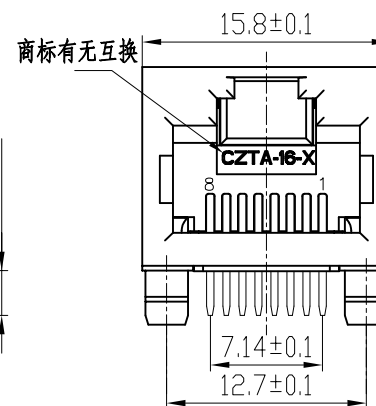

REV. 版本	ECN NO. 变更说明	DATE 日期
01	56LED-B结构图面	2013.11.12
02-04	新增料号	2015.06.13
05-07	此页未变更	2015.08.19

- 2.1 胶壳: 见表格
- 2.2 金针: 0.36X0.46磷青铜;
- 2.3 接触区可选(见料号表格),
镍底50u", 电镀雾锡150u";
- 2.4 信赖性: 750次
- 2.5 插入力/拔出力: 30N Max.
- 2.6 配合强度: 50N FOR 60S $\pm 5\text{S}$.

A

B

C

D

RoHS Compliant

56LED-B单胞 8P8C

CZT ® 温州意华接插件股份有限公司 WENZHOU YIHUA CONNECTOR CO., LTD				TOLERANCES 公差 00~15 ± 0.15 15~30 ± 0.20 30~ ± 0.25 ANGLES $\pm 1^\circ$	Material: 材质 SEE_NOTE	Designed: 设计 陈智艳	NAME: 名称	56LED-B单胞 8P8C 不带灯不包铁	
Finish: 电镀 SEE_NOTE					Checked: 审核		DWG NO: 图号	E56131203	REV. 版本
SHEET 1 OF 4 第 1 页 共 4 页					Approved: 核准		PART NO: 料号	见表格	07

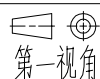
A4
SIZESCALE
比例
1:1UNIT
单位
mmCUSTOMER:
客户
MODEL NO:
料号

1

2

3

4

REV. 版本	ECN NO. 变更说明	DATE 日期
01	56LED-B结构图面	2013. 11. 12
02-07	新增料号	2015. 08. 19
05-06	此页未变更	2015. 08. 04

P/N 料号	DESCRIPTION 描述	MATERIAL COLOR	LOGO商标	脚径	A尺寸
△ 10221188B102	RJ45 1X1 56LED-B 8P8C W/O SHIELD W/O LED /56LED-B单胞 8P8C 3u" 无灯孔	PBT BLACK黑	无CZT	Ø3. 35	2.86±0.25
10221188A163	RJ45 1X1 56LED-B 8P8C W/O SHIELD W/O LED /56LED-B单胞 8P8C G/F 无灯孔	PA46 BLACK黑	无CZT	Ø3. 35	2.86±0.25
△ 10221188C031	RJ45 1X1 56LED-B 8P8C W/O SHIELD W/O LED /56LED-B单胞 8P8C 50u" 无灯孔	PBT BLACK黑	无CZT	Ø3. 35	2.86±0.25
10221188B082	RJ45 1X1 56LED-B 8P8C W/O SHIELD W/O LED /56LED-B单胞 8P8C 3u" 无灯孔	PA66 BLACK 黑	带CZT	Ø3. 35	2.86±0.25
10221188A146	RJ45 1X1 56LED-B 8P8C W/O SHIELD W/O LED /56LED-B单胞 8P8C G/F 无灯孔	PBT YELLOW 黄114C	无CZT	Ø3. 35	2.86±0.25
10221188C074	RJ45 1X1 56LED-B 8P8C W/O SHIELD W/O LED /56LED-B单胞 8P8C 6u" 无灯孔	PBT BLACK黑	无CZT	Ø3. 35	2.86±0.25
10221188A135	RJ45 1X1 56LED-B 8P8C W/O SHIELD W/O LED /56LED-B单胞 8P8C G/F 无灯孔	PBT WHITE 白	无CZT	Ø3. 35	2.86±0.25
10221188C073	RJ45 1X1 56LED-B 8P8C W/O SHIELD W/O LED /56LED-B单胞 8P8C 6u" 无灯孔	PA46 BLACK黑	无CZT	Ø3. 35	2.86±0.25
10221188A131	RJ45 1X1 56LED-B 8P8C W/O SHIELD W/O LED /56LED-B单胞 8P8C G/F 无灯孔	PBT BLACK黑	无CZT	Ø3. 35	2.86±0.25
10221188D029	RJ45 1X1 56LED-B 8P8C W/O SHIELD W/O LED /56LED-B单胞 8P8C 15u" 无灯孔	PBT BLACK黑	无CZT	Ø3. 35	2.86±0.25
10221188B107	RJ45 1X1 56LED-B 8P8C W/O SHIELD W/O LED /56LED-B单胞 8P8C 3u" 无灯孔	PBT WHITE白	无CZT	Ø3. 35	2.86±0.25
10221188B108	RJ45 1X1 56LED-B 8P8C W/O SHIELD W/O LED /56LED-B单胞 8P8C 3u" 无灯孔	PBT GRAY灰	无CZT	Ø3. 35	2.86±0.25
10221188C093	RJ45 1X1 56LED-B 8P8C W/O SHIELD W/O LED /56LED-B单胞 8P8C 6u" 无灯孔	PBT WHITE白	无CZT	Ø3. 35	2.86±0.25
△ 10221188C094	RJ45 1X1 56LED-B 8P8C W/O SHIELD W/O LED /56LED-B单胞 8P8C 6u" 无灯孔	PBT GRAY灰	无CZT	Ø3. 35	2.86±0.25
10221188A209	RJ45 1X1 56LED-B 8P8C W/O SHIELD W/O LED /56LED-B单胞 8P8C G/F 无灯孔	PBT BLUE 蓝285C	无CZT	Ø3. 35	2.86±0.25
△ 10221188A241	RJ45 1X1 56LED-B 8P8C W/O SHIELD W/O LED /56LED-B单胞 8P8C G/F 无灯孔	普通PBT紫268U(环保料)	带CZT	Ø3. 35	2.86±0.25
10221188D045	RJ45 1X1 56LED-B 8P8C W/O SHIELD W/O LED /56LED-B单胞 8P8C 15u" 无灯孔	PA66 BLACK黑	无CZT	Ø3. 35	2.86±0.25
△ 10221188C138	RJ45 1X1 56LED-B 8P8C W/O SHIELD W/O LED /56LED-B单胞 8P8C 6u" 无灯孔	普通PBT蓝285C(环保料)	无CZT	Ø3. 35	2.86±0.25
10221188B130	RJ45 1X1 56LED-B 8P8C W/O SHIELD W/O LED /56LED-B单胞 8P8C 3u" 无灯	PBT BLACK黑	带CZT	Ø3. 35	3.3±0.25
10221188B140	RJ45 1X1 56LED-B 8P8C W/O SHIELD W/O LED /56LED-B单胞 8P8C 3u" 无灯	普通PBT蓝312C(环保料)	无CZT	Ø3. 35	2.86±0.25
10221188B141	RJ45 1X1 56LED-B 8P8C W/O SHIELD W/O LED /56LED-B单胞 8P8C 3u" 无灯	普通PBT黄123C(环保料)	无CZT	Ø3. 35	2.86±0.25
10221188B125	RJ45 1X1 56LED-B 8P8C W/O SHIELD W/O LED /56LED-B单胞 8P8C 3u" 无灯孔刻日期	PA46 BLACK黑	带CZT	Ø3. 35	2.86±0.25
10221188C137	RJ45 1X1 56LED-B 8P8C W/O SHIELD W/O LED /56LED-B单胞 8P8C 6u" 无灯孔	PBT BLACK黑	带CZT	Ø3. 35	3.3±0.25
10221188F077	RJ45 1X1 56LED-B 8P8C W/O SHIELD W/O LED /56LED-B单胞 8P8C 30u" 无灯孔	PA66 BLACK黑	带CZT	Ø3. 35	3.3±0.25
10221188A265	RJ45 1X1 56LED-B 8P8C W/O SHIELD W/O LED /56LED-B单胞 8P8C G/F 无灯孔	PBT BLACK黑	带CZT	Ø3. 35	2.86±0.25

RoHS Compliant

56LED-B单胞 8P8C

CZT ® 温州意华接插件股份有限公司 WENZHOU YIHUA CONNECTOR CO., LTD				TOLERANCES 公差 00~15 ± 0.15 15~30 ± 0.20 30~ ± 0.25 ANGLES ±1°	Material: 材 质 SEE_NOTE	Designed: 设 计 陈智艳	NAME: 名 称 56LED-B单胞 8P8C 不带灯不包铁
Finish: 电 镀 SEE_NOTE				Checked: 审 核		DWG NO: 图 号 E56131203	REV. 版本
SHEET 2 OF 4 第 页 共 页				Approved: 核 准		PART NO: 料 号 见表格	07



A4
SIZE

SCALE
比例
1:1

UNIT
单位
mm

CUSTOMER:
客 户

MODEL NO:
料 号